

# Fan Heaters

## Type TXI, WBK, WBG, Delta & VLE

Sinus Jevi has an extensive program of high quality fan heaters for every application. From cost effective model TXI to high power stationary model VLE, all heaters represent our many years of experience with electric heating equipment. Sinus Jevi fan heaters are characterized by their robust and efficient design in which only the best materials and most reliable components are integrated.



# SINUS JEVI



Liquids



Gasses



Solids



Spaces



Resistors

## TXI

Cost effective electric fan heater type TXI is suitable for light industrial use and other less demanding applications. These heaters are especially convenient for mobile use.

The fan-heaters are ideally suited for heating small- and medium-sized premises such as living rooms, workshops, garages, shops, storerooms, summer cottages, etc. Even larger premises, such as greenhouses, sports- and factory facilities can, by using or combining several fan-heaters, be sufficiently heated. TXI fan-heaters are manufactured and approved according to current European standards.

TXI fan heaters are produced with coated steel cabinets and with insulated safety handles. Stainless steel tubular heating elements ensure reliable and efficient heat transfer to the air flow. The fan motors do not require any specific maintenance. Both a control thermostat and safety thermostat with manual reset are a part of the heater design. With the aid of a rotary switch it is possible to select the operation mode: heater off, fan only, half power or full power. Model TXI 90 has the possibility to select between 3 power modes: 3 kW, 6 kW and 9 kW. More technical details can be found in table 2.

TXI 33 is equipped with 2 metres power cable including a (230 VAC / 50 Hz) Schuko plug. The other models have to be connected to the mains with an external mains connection cable. See table 1 for available cables.



Heater type	Article code	EAN code	Cable type	Cable length	Description
TXI 50 / TXI 90	0547531625A	8715179007287	TXI-CAB-16-2	2 m	Cable 2m 2.5mm <sup>2</sup> IP44 16A 5P
TXI 50 / TXI 90	0547531625B	8715179007294	TXI-CAB-16-5	5 m	Cable 5m 2.5mm <sup>2</sup> IP44 16A 5P
TXI 150	0547533240A	8715179007300	TXI-CAB-32-2	2 m	Cable 2m 4.0mm <sup>2</sup> IP44 32A 5P
TXI 150	0547533240B	8715179007317	TXI-CAB-32-5	5 m	Cable 5m 4.0mm <sup>2</sup> IP44 32A 5P

Type	TXI 33	TXI 50	TXI 90	TXI 150
Power	1,65 / 3,3 kW	2,5 / 5 kW	3 / 6 / 9 kW	7,5 / 15 kW
Current	14,3A	7,2A	13,5A	21,6A
Supply voltage	230 Volt / 50 Hz	3 x 400 Volt / 50 Hz	3 x 400 Volt / 50 Hz	3 x 400 Volt / 50 Hz
Mains connection	2m cable with Schuko plug	surface mounted CEE plug 5P / 16A	surface mounted CEE plug 5P / 16A	surface mounted CEE plug 5P / 32A
Operation modes	Off / fan only / half power / full power	Off / fan only / half power / full power	Off / fan only / 1/3 power 2/3 power / full power	Off / fan only / half power / full power
Temperature controller	built-in thermostat	built-in thermostat	built-in thermostat	built-in thermostat
Air volume flow	400 m <sup>3</sup> /h	400 m <sup>3</sup> /h	700 m <sup>3</sup> /h	1300 m <sup>3</sup> /h
Weight	7.5 kg	8 kg	10 kg	15.5 kg
Enclosure colour	yellow	yellow	yellow	yellow
Fan diameter	230 mm	230 mm	254 mm	300 mm
Dimensions Width	250 mm	250 mm	350 mm	350 mm
Depth	250 mm	250 mm	330 mm	440 mm
Height	420 mm	420 mm	480 mm	600 mm
Protection degree	IP44	IP44	IP44	IP44
Article number	753 001 0331A	753 001 0503A	753 001 0903A	753 001 1503A
EAN code	8715179007218	8715179007225	8715179007232	8715179007249

## WBK

Our WBK air heaters have been designed for industrial application. Because of their high reliability, they are especially suitable for all applications at an ambient temperature of up to 35°C.

As the construction of the WBK is in accordance with IP44 insulation class I, it is also suitable for use in damp spaces (spray-proof). Because of the low surface temperature, it is safe to use in places of easy access. However, it is not to be used in spaces containing flammable or combustible materials. The heater is made of stainless steel closed tubular elements, in which a glow-spiral is encased, in a 1- or 3-phase construction. It is designed for durability and provided with pre-heating and lag control. Connection is via cable gland at the back.

## CONSTRUCTION

WBK air heaters consist of a steel housing, containing closed tubular elements, along which a 1-phase fan blows air. In order to distribute warmth evenly, they have a high air-output. These heaters are delivered with a universal bracket, allowing them to be mounted on the floor, the wall or the ceiling.

**Finish:** a durable layer of red epoxy paint for the housing and a layer of black epoxy paint for the bracket. Connection for an external room thermostat is provided as standard.

This appliance meets the CE directives.

## APPLICATION

For industrial application in drying rooms, as frost protection, in engine rooms, workshops, etc.

They can also be used as domestic appliances in garages, cellars, offices, etc.

## STANDARD VOLTAGES

230 Volt AC 1-phase, 50 Hz.

3x400 Volt 3-phase, 50 Hz.



<b>TECHNICAL DATA</b>		<b>WBK-TYPE UNIVERSAL AIR HEATERS</b>			
<b>Type</b>		<b>WBK 2</b>	<b>WBK 3</b>	<b>WBK 3/3</b>	<b>WBK 4,5/3</b>
Output		2 kW	3 kW	3 kW	4,5 kW
Connection voltage		230 Volt	230 Volt	3x400 Volt	3x400 Volt
Current intensity		8.7 A	13 A	3 x 5.8 A	3 x 6.5 A
Control possibilities		-	-	-	-
Temperature increase		20 °C	28 °C	28 °C	42 °C
Temperature adjustability		external thermostat	external thermostat	external thermostat	external thermostat
Air volume		300 m³/h	300 m³/h	300 m³/h	300 m³/h
Weight		9 kg	9 kg	9.5 kg	9.5 kg
Dimensions	Width	340 mm	340 mm	340 mm	340 mm
	Depth	300 mm	300 mm	300 mm	300 mm
	Height	380 mm	380 mm	380 mm	380 mm
Max. height incl. bracket		410 mm	410 mm	410 mm	410 mm
Article number		761 098 0223A	761 098 0323A	761 098 0340A	761 098 0440A
EAN code		8715179003456	8715179003463	8715179003470	8715179003487

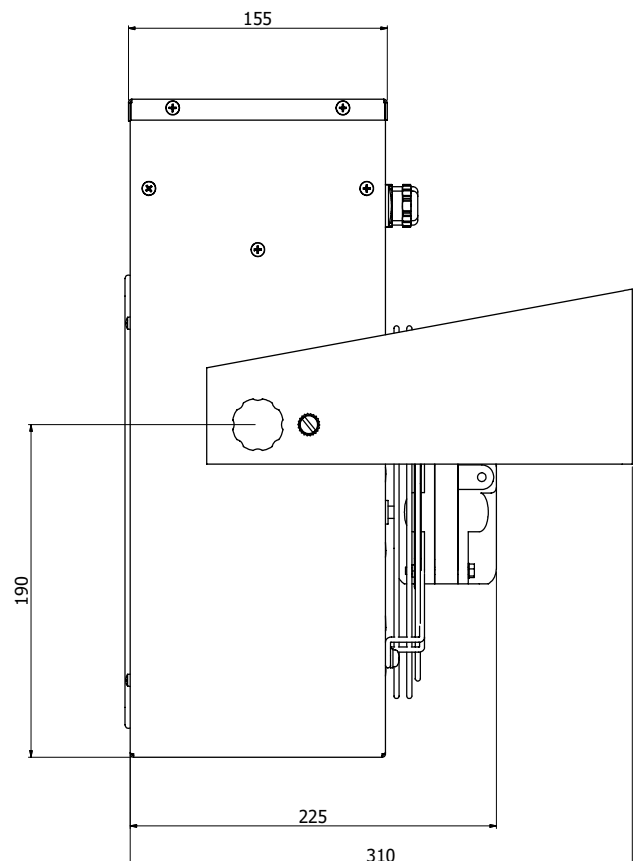
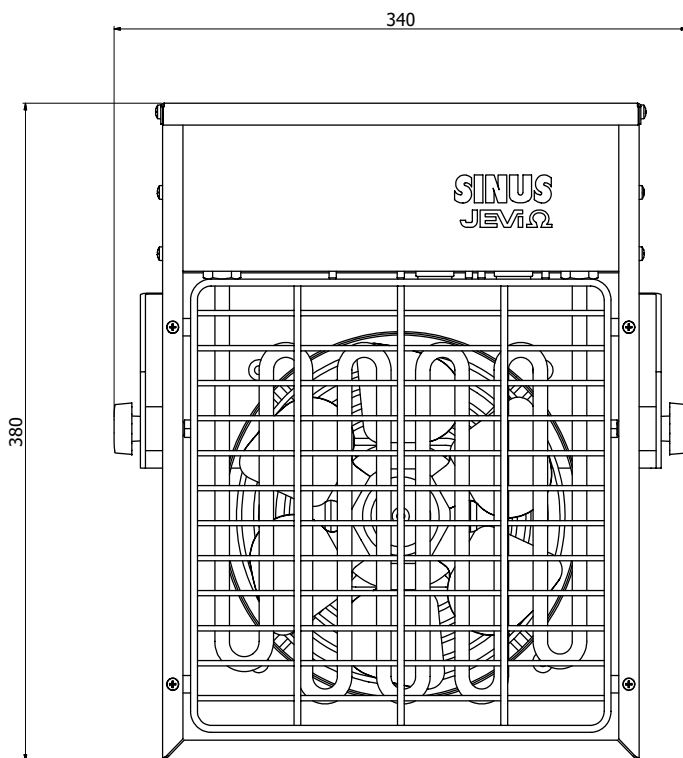

## WBG

Our WBG air heaters have been designed for industrial application. Because of their high reliability, they are especially suitable for all heating applications at an ambient temperature of up to 35°C.

As the WBG's construction is in accordance with IP44 insulation class I, it is also suitable for use in damp spaces (spray-proof). Because of the low surface temperature, it is suitable for use in places of easy access. However, it is not to be used in spaces containing flammable or combustible materials.

The heater is made of stainless steel closed tubular elements, in which a glow-spiral is encased, in 3-phase construction. It is designed for durability. The WBG can also be connected 1 phase. Connection is via a cable gland at the back. As standard, these air heaters are provided with a group switch, preheating and lag control and have a connection for an external room thermostat.

## CONSTRUCTION

WBG air heaters consist of a steel housing, containing closed tubular elements, along which the built-in fan blows air. In order to distribute warmth evenly, they have a high air-output. This also gives the heaters their high drying capacity.

These heaters are delivered with a universal bracket, allowing them to be mounted on the floor, the wall or the ceiling.

**Finish:** a durable layer of red epoxy paint for the housing and a layer of black epoxy paint for the bracket. The air heater is spray-proof (IP44)

## APPLICATION

For industrial application in drying rooms, as frost protection, in engine rooms, work shops and so forth. They can also be used as a domestic appliances in garages, cellars, offices, etc.

## STANDARD VOLTAGES

3x400 Volt AC 3 phase, 50 Hz.



<b>TECHNICAL DATA</b>		<b>WBG-TYPE UNIVERSAL AIR HEATERS</b>			
<b>Type</b>		<b>WBG 6</b>	<b>WBG 9</b>	<b>WBG 12</b>	<b>WBG 15</b>
Output		6 kW	9 kW	12 kW	15 kW
Connection voltage		3 x 400 Volt	3 x 400 Volt	3 x 400 Volt	3 x 400 Volt
Current intensity		3 x 8.7 A	3 x 13 A	3 x 17.4 A	3 x 21.7 A
Control possibilities		3 - 6 kW	4.5 - 9 kW	6 - 12 kW	7.5 - 15 kW
Temperature increase		25°C	38°C	25°C	32°C
Temperature adjustability		external thermostat	external thermostat	external thermostat	external thermostat
Air volume		650 m <sup>3</sup> /h	650 m <sup>3</sup> /h	1300 m <sup>3</sup> /h	1300 m <sup>3</sup> /h
Weight		16.5 kg	16.5 kg	17 kg	17 kg
Dimensions	Width	430 mm	430 mm	430 mm	430 mm
	Depth	360 mm	360 mm	360 mm	360 mm
	Height	500 mm	500 mm	500 mm	500 mm
Max. height incl. bracket		565 mm	565 mm	565 mm	565 mm
Article number		762 098 0640A	762 098 0940A	762 098 1240A	762 098 1540A
EAN code		8715179003494	8715179003500	8715179003517	8715179003524

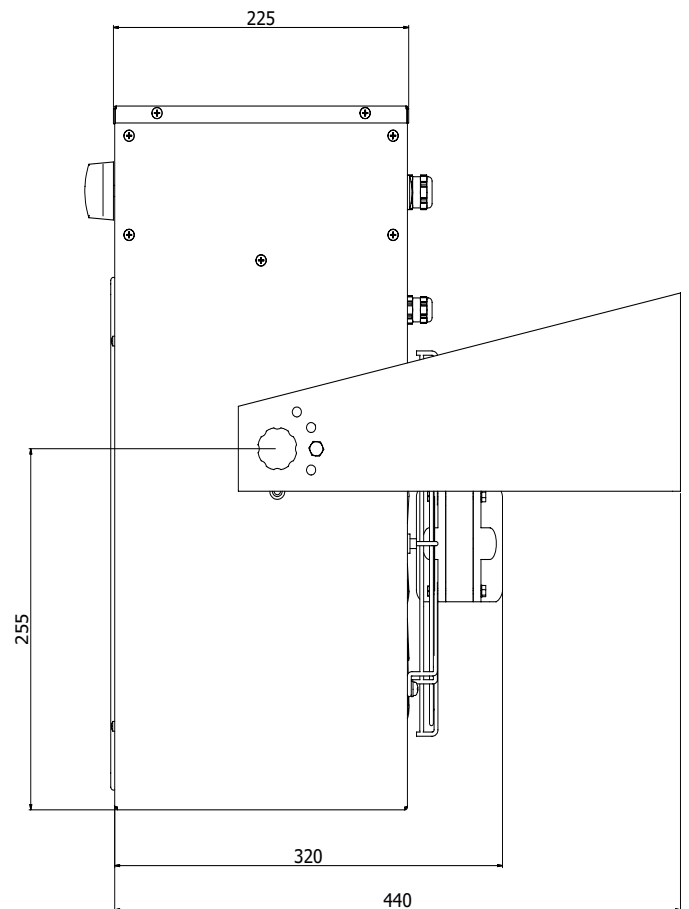
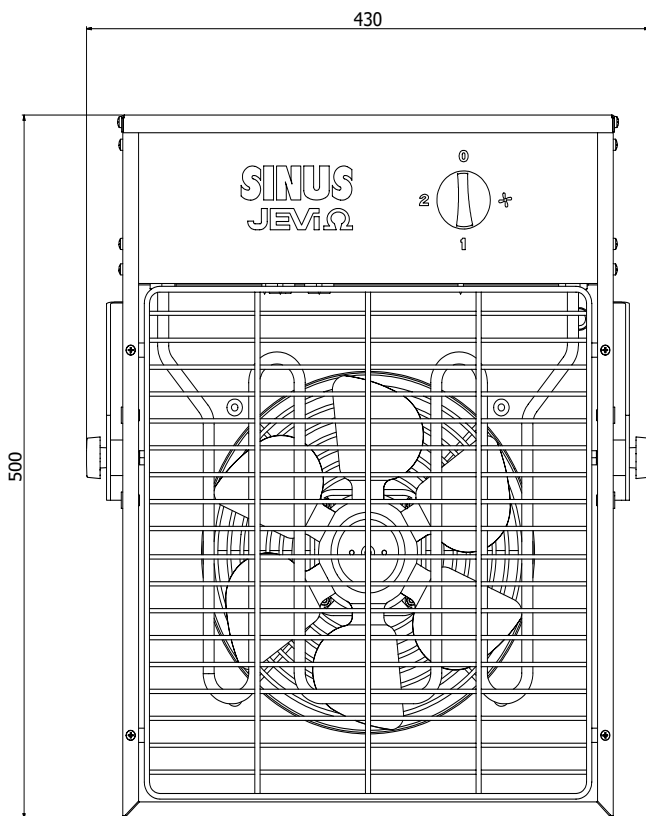

## DELTA

Delta is rigid and reliable fan heater designed for harsh weather and rough environments, where fine materials and performance are required for example on building and construction sites or in ship building industries. Delta is also used for more permanent installations in production areas, warehouses, garages, factories and stables. It is easy to change from portable to permanent by using a wall bracket instead of the hand rail. The wall bracket must be ordered separately.

### TECHNICAL DATA

Delta is supplied with a 0 - 40°C thermostat which ensures an optimum service and minimizes the electrical consumption. A thermocut is also installed for safety against superheating. You can also order Delta heaters supplied with a 24 hour timerfunction (T). Delta is designed with an inner round shell which ensures that the entire air flow passes over the heating elements. In this way problems with cold areas and stalling airflow are avoided.

The fan heater is supplied in 3 x 400 V + PE, but very often applications require different voltages, therefore all types are available from 110 V - 690 V.  
Delta is moisture proof to IPX4.

### PERMANENT INSTALLATION

The hand rail is removed, and by using the wall bracket the fan heater can be mounted vertically or in a 15° angle.

### ELECTRICAL INSTALLATION

Permanent installation must be carried out by an authorised electrician in compliance with current regulations.

### COATING

Delta is constructed of electrogalvanized steelplates coated with a 20 my coating in RAL 7004 (light grey).

In larger quantities the fan heaters can be supplied in other colours.



TECHNICAL DATA			DELTA UNIVERSAL AIR HEATERS					
Type	Output	Voltage	Width	Height	Depth	Weight	M³/h	Article number
Delta 3000 (A)	3 kW	230 Volt	410 mm	435 mm	420 mm	approx. 14 kg	400/650	754 030 230A
Delta 3000T (A)	3 kW	230 Volt	410 mm	435 mm	420 mm	approx. 14 kg	400/650	754 030 230T
Delta 3000 (A)	3 kW	3 x 400 Volt	410 mm	435 mm	420 mm	approx. 14 kg	400/650	754 030 400A
Delta 3000T (A)	3 kW	3 x 400 Volt	410 mm	435 mm	420 mm	approx. 14 kg	400/650	754 030 400T
Delta 3000 (A)	3 kW	3 x 440 Volt	410 mm	435 mm	420 mm	approx. 14 kg	400/650	754 030 440A
Delta 6000 (A)	6 kW	3 x 400 Volt	410 mm	435 mm	420 mm	approx. 14,6 kg	400/650	754 060 400A
Delta 6000T (A)	6 kW	3 x 400 Volt	410 mm	435 mm	420 mm	approx. 14,6 kg	400/650	754 060 400T
Delta 6000 (A)	6 kW	3 x 440 Volt	410 mm	435 mm	420 mm	approx. 14,6 kg	400/650	754 060 440A
Delta 9000 (A)	9 kW	3 x 400 Volt	410 mm	435 mm	420 mm	approx. 16 kg	500/800	754 090 400A
Delta 9000T (A)	9 kW	3 x 400 Volt	410 mm	435 mm	420 mm	approx. 16 kg	500/800	754 090 400T
Delta 9000 (A)	9 kW	3 x 440 Volt	410 mm	435 mm	420 mm	approx. 16 kg	500/800	754 090 440A
Delta 15000 (B)	15 kW	3 x 400 Volt	505 mm	540 mm	510 mm	approx. 23 kg	800/1400	754 150 400A
Delta 15000T (B)	15 kW	3 x 400 Volt	505 mm	540 mm	510 mm	approx. 23 kg	800/1400	754 150 400T
Delta 15000 (B)	15 kW	3 x 440 Volt	505 mm	540 mm	510 mm	approx. 23 kg	800/1400	754 150 440A
Delta 21000 (B)	21 kW	3 x 400 Volt	505 mm	540 mm	510 mm	approx. 27 kg	800/1400	754 210 400A
Delta 21000T (B)	21 kW	3 x 400 Volt	505 mm	540 mm	510 mm	approx. 27 kg	800/1400	754 210 400T
Delta 21000 (B)	21 kW	3 x 440 Volt	505 mm	540 mm	510 mm	approx. 27 kg	800/1400	754 210 440A
Wall bracket A								754 000 100A
Wall bracket B								754 000 200A

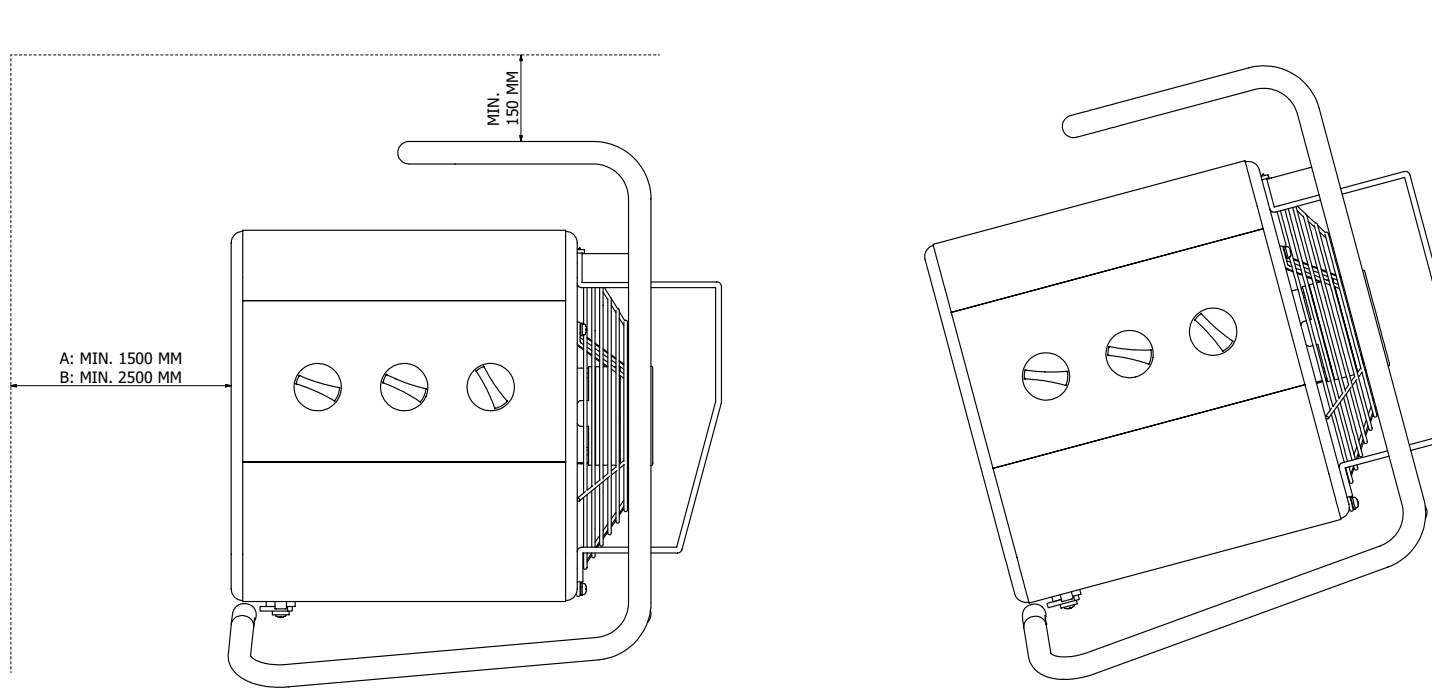

## VLE HEATERS



### VLE

The VLE fan heaters are for fix mounting (non-portable) and are ideal for use in areas where high output is needed. It has a very stable construction and can therefore be used where high vibrations can occur. The fan heater is made of materials able to withstand aggressive effects at sea, on offshore installations, in warehouses and for large manufacturing facilities.

VLE is produced in 2 different types of materials, recommended for following uses:

- ° Stainless steel AISI 316L - for outdoor and corrosive areas like offshore and other harsh environments
- ° Cabinet in galvanized steel and with coated steel control panel mainly for indoor use and non-corrosive areas like onshore use, sports halls, warehouses and manufacturing facilities.

Regardless of which material is selected, the heating elements (stainless steel AISI 316L) are bright annealed.

The power is divided into 3 steps (low - medium - full power). This gives you a fan heater with a large window of power in only one unit. The fan provides an airflow/circulation and air heating for outdoor and indoor installation. Power can easily be changed manually on the outside of the control panel to give you the preferred output. For change of airflow you need an *external fan unit adjustment control* - see under "accessories for VLE fan heaters".

### STANDARDS AND APPROVALS

- ° CE
- ° EN 60335-1:2012
- ° EN 60335-2-30:2009
- ° EN 60204-1:2006
- ° EN 62233:2008
- ° IEC/EN 61000-6-2:2006
- ° IEC/EN 61000-6-4:2007
- ° EN 50581:2012

Our VLE fan heaters can be approved by DNV, ABS and other 3 parties.

### TECHNICAL DATA

#### Voltage range

- ° 1x230 Volt and 3x230 Volt to 3x690 Volt

#### Beschermingsklasse voor ventilatormotor:

- ° IP44 (VLE4)
- ° IP54 (VLE5 of VLE6)

#### Beschermingsklasse regelpaneel:

- ° IP66 voor alle 3 de modellen

#### Integrated room thermostat:

0 - 40°C thermostat, ensuring optimum operation and minimising energy consumption

#### Integrated safety components:

- ° TSH with automatic reset and TSHH with manual reset to prevent the motor to overheat

#### Cable glands:

VLE fan heaters above 16A are pre-fitted with M32 cable glands. Reducing parts for M20 and M25 cable glands are also included. Fan heaters under 16A are pre-fitted with M20. Standard material for cable glands - polyamide. Other material on request.

#### Lifting lugs:

Regardless of model, the heater weighs more than 25kg and is therefore supplied with lifting lugs to ensure better working conditions during installation and maintenance.

### ACCESSORIES FOR VLE FAN HEATERS

In addition to our standard range shown on the following pages, optional extras are available:

- ° External room thermostat 0-40°C, IP44
- ° External room thermostat 0-40°C, IP65
- ° External fan unit start/stop circuit breaker, IP66. Allows the heater to be used to circulate cold air
- ° External fan unit adjustment control. Noise level can be reduced to 50dB at low fan speed.

See our standard range on the next 3 pages.

## VLE HEATERS STANDARD PROGRAMME

### VLE-4

- ° Type: VLE 4
- ° Power: 3-6-9 kW or 3-9-12 kW (3 steps)
- ° Material: Stainless steel AISI 316L or cabinet in galvanized steel with coated control panel.
- ° Size: W630 mm x H460 mm x D590 mm
- ° Frequency: 50/60 Hz
- ° Maximum volume of air at nominal fan speed:  
1700/2000 m<sup>3</sup>/h - 50/60Hz (air volume at low fan speed:  
900/1050 m<sup>3</sup>/h - 50/60 Hz possible with the purchase of a regulator, see previous page)
- ° Maximum throw at nominal fan speed: 10/11 m - 50/60Hz
- ° Degree of protection for control panel: IP66
- ° Degree of protection for fan motor: IP44
- ° Sound level at nominal fan speed: 58dB (measured at a distance of 5 metres from the unit) Can be reduced to 50dB when using a regulator for the fan unit) see page 9.



Article number	Material	Type Power (3 steps)	Voltage	Current (min. supply)	Rise of temperature at nominal fan speed	Weight
4644032302A	Stainless steel AISI 316L	VLE 4 3-6-9 kW	1x230 Volt	13A	5/4°C	40kg
4644092302A			3x230 Volt	23A	5/4°C	45kg
4644093802A			3x380 Volt	14A	5/4°C	42kg
4644094002A			3x400 Volt	13A	10/8°C	42kg
4644094402A			3x440 Volt	12A	10/8°C	42kg
4644094802A			3x480 Volt	11A	16/13°C	42kg
4644096902A			3x690 Volt	8A	16/13°C	42kg
4644122302A	Stainless steel AISI 316	VLE 4 3-9-12 kW	3x230 Volt	31A	5/4°C	46kg
4644123802A			3x380 Volt	19A	5/4°C	46kg
4644124002A			3x400 Volt	18A	16/13°C	46kg
4644124402A			3x440 Volt	16A	16/13°C	46kg
4644124802A			3x480 Volt	15A	21/18°C	43kg
4644126902A			3x690 Volt	11A	21/18°C	43kg
4644092301A	Cabinet Galvanized steel and coated steel control panel	VLE 4 3-6-9 kW	3x230 Volt	23A	5/4°C	42kg
4644093801A			3x380 Volt	14A	5/4°C	42kg
4644094001A			3x400 Volt	13A	10/8°C	42kg
4644094401A			3x440 Volt	12A	10/8°C	42kg
4644094801A			3x480 Volt	11A	16/13°C	42kg
4644096901A			3x690 Volt	8A	16/13°C	42kg
4644122301A	Cabinet Galvanized steel and coated steel control panel	VLE 4 3-9-12 kW	3X230 Volt	31A	5/4°C	46kg
4644123801A			3x380 Volt	19A	5/4°C	46kg
4644124001A			3x400 Volt	18A	16/13°C	46kg
4644124401A			3x440 Volt	16A	16/13°C	46kg
4644124801A			3x480 Volt	15A	21/18°C	43kg
4644126901A			3x690 Volt	11A	21/18°C	43kg

### VLE-5

- ° Type: VLE 5
- ° Power: 6-9-15 kW or 9-15-24 kW (3 steps)
- ° Material: Stainless steel AISI 316L or cabinet in galvanized steel with coated control panel.
- ° Size: W740 mm x H570 mm x D690 mm
- ° Frequency: 50/60 Hz
- ° Maximum volume of air at nominal fan speed:  
3500/4200 m³/h - 50/60Hz (air volume at low fan speed:  
2600/3100 m³/h - 50/60 Hz possible with the purchase of a regulator, see previous page)
- ° Maximum throw at nominal fan speed: 12/14 m - 50/60Hz
- ° Degree of protection for control panel: IP66
- ° Degree of protection for fan motor: IP54
- ° Sound level at nominal fan speed: 65dB (measured at a distance of 5 metres from the unit) Can be reduced to 56dB when using a regulator for the fan unit) see page 9.



Article number	Material	Type Power (3 steps)	Voltage	Current (min. supply)	Rise of temperature at nominal fan speed	Weight
4645152302A	Stainless steel AISI 316L	VLE 5 6-9-15 kW	3x230 Volt	38A	6/5°C	62kg
4645153802A			3x380 Volt	23A	6/5°C	58kg
4645154002A			3x400 Volt	22A	9/8°C	58kg
4645154402A			3x440 Volt	20A	9/8°C	58kg
4645154802A			3x480 Volt	19A	16/13°C	58kg
4645156902A			3x690 Volt	13A	16/13°C	58kg
4645242302A	Stainless steel AISI 316	VLE 5 9-15-24 kW	3x230 Volt	61A	9/7°C	65kg
4645243802A			3x380 Volt	37A	9/7°C	65kg
4645244002A			3x400 Volt	35A	16/13°C	65kg
4645244402A			3x440 Volt	32A	16/13°C	65kg
4645244802A			3x480 Volt	29A	26/21°C	61kg
4645246902A			3x690 Volt	21A	26/21°C	61kg
4645152301A	Cabinet Galvanized steel and coated steel control panel	VLE 5 6-9-15 kW	3x230 Volt	38A	6/5°C	62kg
4645153801A			3x380 Volt	23A	6/5°C	58kg
4645154001A			3x400 Volt	22A	9/8°C	58kg
4645154401A			3x440 Volt	20A	9/8°C	58kg
4645154801A			3x480 Volt	19A	16/13°C	58kg
4645156901A			3x690 Volt	13A	16/13°C	58kg
4645242301A	Cabinet Galvanized steel and coated steel control panel	VLE 5 9-15-24 kW	3X230 Volt	61A	9/7°C	65kg
4645243801A			3x380 Volt	37A	9/7°C	65kg
4645244001A			3x400 Volt	35A	16/13°C	65kg
4645244401A			3x440 Volt	32A	16/13°C	65kg
4645244801A			3x480 Volt	29A	26/21°C	61kg
4645246901A			3x690 Volt	21A	26/21°C	61kg

### VLE-6

- ° Type: VLE 6
- ° Power: 12-18-30 kW or 12-24-36 kW (3 steps)
- ° Material: Stainless steel AISI 316L or cabinet in galvanized steel with coated control panel.
- ° Size: W855 mm x H685 mm x D760 mm
- ° Frequency: 50/60 Hz
- ° Maximum volume of air at nominal fan speed:  
5300/6300 m<sup>3</sup>/h - 50/60Hz (air volume at low fan speed:  
3700/4400 m<sup>3</sup>/h - 50/60 Hz possible with the purchase of a regulator, see previous page)
- ° Maximum throw at nominal fan speed: 15/18 m - 50/60Hz
- ° Degree of protection for control panel: IP66
- ° Degree of protection for fan motor: IP54
- ° Sound level at nominal fan speed: 68dB (measured at a distance of 5 metres from the unit) Can be reduced to 58dB when using a regulator for the fan unit) see page 9.



Article number	Material	Type Power (3 steps)	Voltage	Current (min. supply)	Rise of temperature at nominal fan speed	Weight
4646304002A	Stainless steel AISI 316L	VLE 6 12-18-30 kW	3x400 Volt	44A	7/6°C	80kg
4646304402A			3x440 Volt	40A	12/9°C	80kg
4646304802A			3x480 Volt	37A	19/15°C	80kg
4646306902A			3x690 Volt	26A	19/15°C	80kg
4646364002A	Stainless steel AISI 316	VLE 6 12-24-36 kW	3x400 Volt	52A	7/6°C	82kg
4646364402A			3x440 Volt	48A	16/12°C	82kg
4646364802A			3x480 Volt	44A	23/18°C	82kg
4646366902A			3x690 Volt	31A	23/18°C	82kg
4646304001A	Cabinet Galvanized steel and coated steel control panel	VLE 6 12-18-30 kW	3x400 Volt	44A	7/6°C	80kg
4646304401A			3x440 Volt	40A	12/9°C	80kg
4646304801A			3x480 Volt	37A	19/15°C	80kg
4646306901A			3x690 Volt	26A	19/15°C	80kg
4646364001A	Cabinet Galvanized steel and coated steel control panel	VLE 5 12-24-36 kW	3x400 Volt	52A	7/6°C	82kg
4646364401A			3x440 Volt	48A	16/12°C	82kg
4646364801A			3x480 Volt	44A	23/18°C	82kg
4646366901A			3x690 Volt	31A	23/18°C	82kg

### SHK 15 (TORNADO)

3 x 400 Volt. With built-in room thermostat (0-40°C and frost protection). Unique residual heat control, thermal protection, fan setting and wheel set. There is a connection for an external room thermostat (RTC) and flexi pipe. The SHK15 is waterproof IP44.



### SHK 10 (TYPHOON)

3 x 400 Volt. With unique residual heat control, thermal protection, fan setting and wheel set.

There is a connection for an external room thermostat (RTC) and flexi pipe. The SHK 15 is waterproof IP44.

### FLEXI-PIPE

A flexible air hose of 6 meters with coupler. For heating in inaccessible places.

Applicable for SHK 10 and 15.

<b>TECHNICAL DATA</b>		<b>ELECTRICAL HOT-AIR BLOWERS</b>	
<b>Type</b>	<b>SHK 10</b>	<b>SHK 15</b>	
Output	10 kW	15 kW	
Current intensity	14.5A	21.8A	
Connection voltage	3 x 400 Volt	3 x 400 Volt	
Control possibilities	6.5 - 10 kW	7.5 - 15 kW	
Temperature increase	50°C	60°C	
Temperature adjustability	RTC	0 - 40°C (RTC)	
Air volume	600 m³/h	700 m³/h	
Weight	28.8 kg	38.4 kg	
Dimensions Width	990 mm	1115 mm	
Depth	580 mm	650 mm	
Height	360 mm	390 mm	
Article number	745 096 0001A	747 092 001A	
EAN code	8715179001780	8715179001797	

---

# SINUS JEVI

Sinus was one of the pioneers in the field of explosion proof heating equipment, today we are still operating at the forefront. We design and manufacture according to ATEX as well as IECEx and EAC directives.

Our company is certified to design and produce Ex-equipment. and we also in the possession of ISO 9001 and ISO 14001 certificates.

## NIBE